



Raccord bicone serie B400

RACCORD BICONE SERIE B400

Domaine d application

Circuiti pneumatici, e idraulici

Raccords

Les raccords tuyaux et les écrous de vis sont fabriqués selon la norme DIN 3870-3861

Tubes

Pour des tuyaux en métal (cuivre - laiton - acier - aluminium - etc.)
Pour des tuyaux en plastique intérieurement renforcés (- nylon - le polyuréthane filsan etc.)
La pression et la température d'utilisation maximum dépendent des caractéristiques des tuyaux choisis.
Pression maximum suggérée. barre 60

Matériaux utilisés

Laiton UNI EN 12164 CW 614N
Laiton UNI EN 12165 CW 617N

Finition de la surface

Nickele

Filetage

Conique - ISO 7 - DIN 2999 - BS 21
Cylindrique - ISO 228

D401

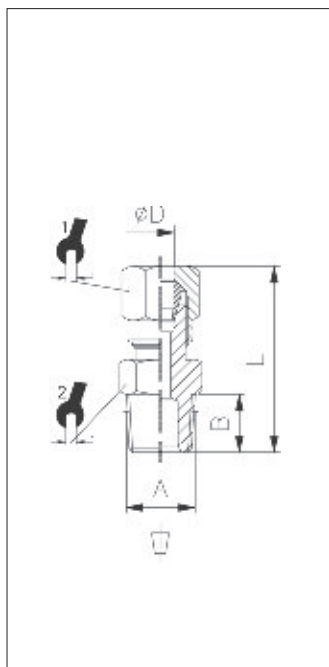

DROIT MALE CONIQUE

CODE	ØD	A	B	L			
D401 4-1/8	4,0	R1/8	8,0	27,0	10	10	50
D401 6-1/8	6,0	R1/8	8,0	28,0	12	12	50
D401 6-1/4	6,0	R1/4	11,0	32,5	12	14	50
D401 8-1/8	8,0	R1/8	8,0	29,5	14	12	50
D401 8-1/4	8,0	R1/4	11,0	33,0	14	14	50
D401 8-3/8	8,0	R3/8	11,5	33,0	14	17	50
D401 10-1/4	10,0	R1/4	11,0	37,5	19	17	50
D401 10-3/8	10,0	R3/8	11,5	38,0	19	17	50
D401 10-1/2	10,0	R1/2	14,0	40,5	19	22	25
D401 12-3/8	12,0	R3/8	11,5	39,0	22	19	25
D401 12-1/2	12,0	R1/2	14,0	41,0	22	22	25
D401 14-1/2	14,0	R1/2	14,0	42,5	27	22	20
D401 15-1/2	15,0	R1/2	14,0	42,5	27	22	20
D401 16-1/2	16,0	R1/2	14,0	42,0	30	24	10
D401 18-1/2	18,0	R1/2	14,0	43,0	32	26	10

D402

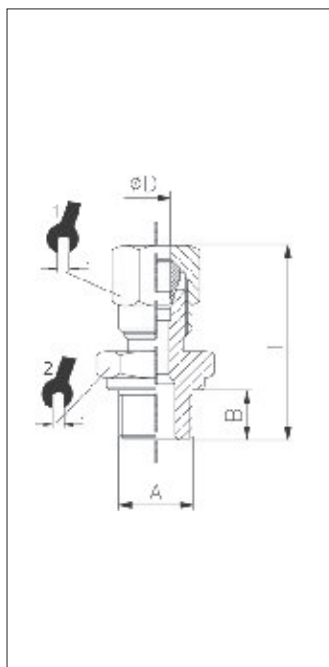

DROIT MALE CYLINDRIQUE

CODE	ØD	A	B	L			
D402 4-1/8	4,0	G1/8	6,0	25,0	10	14	50
D402 6-1/8	6,0	G1/8	6,0	26,0	12	14	50
D402 6-1/4	6,0	G1/4	8,0	29,5	12	17	50
D402 8-1/8	8,0	G1/8	6,0	27,5	14	14	50
D402 8-1/4	8,0	G1/4	8,0	30,0	14	17	50
D402 8-3/8	8,0	G3/8	9,0	30,5	14	19	50
D402 10-1/4	10,0	G1/4	8,0	34,5	19	17	50
D402 10-3/8	10,0	G3/8	9,0	36,0	19	19	50

D403

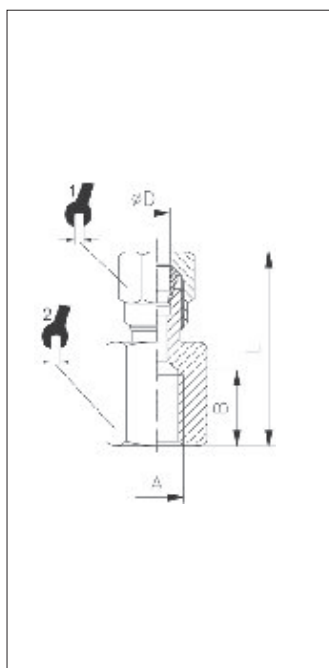

DROIT FEMELLE CYLINDRIQUE

CODE	ØD	A	B	L			
D403 4-1/8	4	G1/8	8,0	24,5	10	14	50
D403 6-1/8	6	G1/8	8,0	26,0	12	14	50
D403 6-1/4	6	G1/4	11,0	30,5	12	17	50
D403 8-1/8	8	G1/8	8,0	26,5	14	14	50
D403 8-1/4	8	G1/4	11,0	31,0	14	17	50
D403 8-3/8	8	G3/8	11,5	31,0	14	20	50
D403 10-1/4	10	G1/4	11,0	35,5	19	17	50
D403 10-3/8	10	G3/8	11,5	36,5	19	20	50
D403 12-3/8	12	G3/8	11,5	37,0	22	20	25
D403 12-1/2	12	G1/2	15,0	38,5	22	24	25
D403 14-1/2	14	G1/2	15,0	40,0	27	24	20
D403 15-1/2	15	G1/2	15,0	40,5	27	24	20
D403 16-1/2	16	G1/2	15,0	41,5	30	24	10
D403 18-1/2	18	G1/2	15,0	43,0	32	24	10

D404

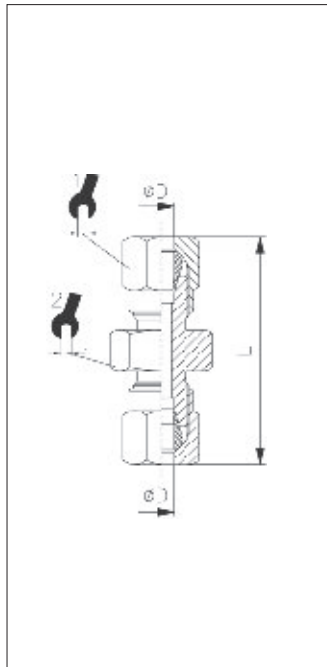

UNION

CODE	ØD	L			
D404 4	4,0	33,5	10	10	50
D404 6	6,0	36,5	12	12	50
D404 8	8,0	38,5	14	14	50
D404 10	10,0	47,5	19	17	50
D404 12	12,0	50,5	22	19	20
D404 14	14,0	55,5	27	24	20
D404 15	15,0	55,5	27	24	20
D404 16	16,0	58,0	30	24	10
D404 18	18,0	60,0	32	26	10

D416

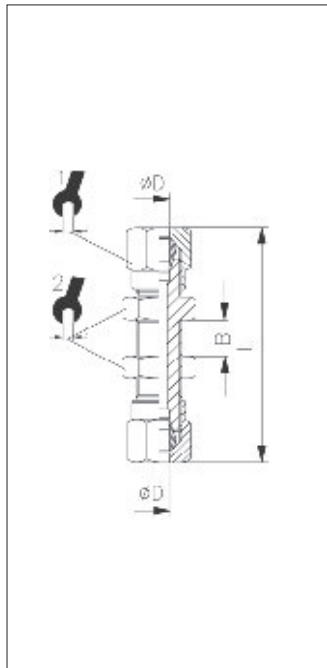

TRAVERSEE DE CLOISON

CODE	ØD	Bmax	L			
D416 6	6,0	15,5	51,5	12	14	50
D416 8	8,0	16,5	55,5	14	16	50
D416 10	10,0	15,5	62,5	19	19	50
D416 12	12,0	16,0	64,5	22	22	20
D416 14	14,0	18,0	69,5	27	25	20
D416 15	15,0	18,0	69,5	27	25	10

D405

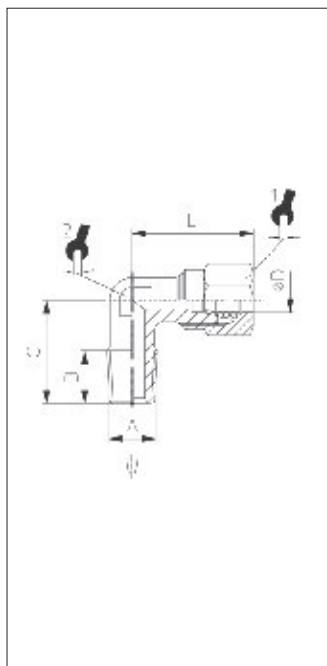

EQUERRE MALE CONIQUE

CODE	ØD	A	B	C	L			
D405 4-1/8	4	R1/8	8,0	16,0	21,0	10	9	50
D405 6-1/8	6	R1/8	8,0	16,0	22,0	12	9	50
D405 6-1/4	6	R1/4	11,0	20,0	24,5	12	11	50
D405 8-1/8	8	R1/8	8,0	17,0	24,0	14	11	50
D405 8-1/4	8	R1/4	11,0	20,0	24,0	14	11	50
D405 8-3/8	8	R3/8	11,5	24,0	27,0	14	13	50
D405 10-1/4	10	R1/4	11,0	23,5	32,0	19	13	50
D405 10-3/8	10	R3/8	11,5	24,0	32,0	19	13	50
D405 10-1/2	10	R1/2	14,0	28,5	34,0	19	15	25
D405 12-3/8	12	R3/8	11,5	25,5	34,5	22	15	25
D405 12-1/2	12	R1/2	14,0	28,5	34,5	22	15	25
D405 14-1/2	14	R1/2	14,0	30,0	38,0	27	17	20
D405 15-1/2	15	R1/2	14,0	30,0	38,0	27	17	20
D405 16-1/2	16	R1/2	14,0	31,5	39,5	30	19	10
D405 18-1/2	18	R1/2	14,0	34,0	44,0	32	22	10

D407

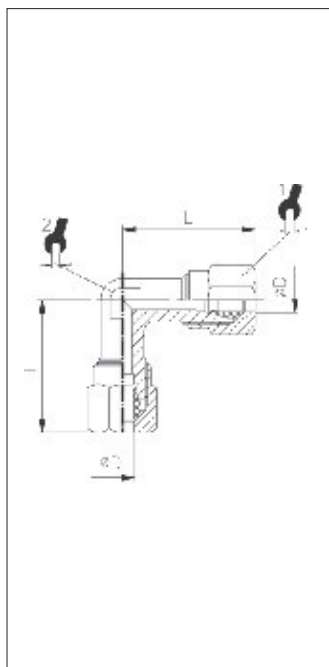

EQUERRE EGALE

CODE	ØD	L			
D407 4	4,0	21,0	10	9	50
D407 6	6,0	23,0	12	9	50
D407 8	8,0	24,0	14	11	50
D407 10	10,0	32,0	19	13	50
D407 12	12,0	34,5	22	15	20
D407 14	14,0	38,0	27	17	20
D407 15	15,0	38,0	27	17	20
D407 16	16,0	39,5	30	19	10
D407 18	18,0	44,0	32	22	10

D409

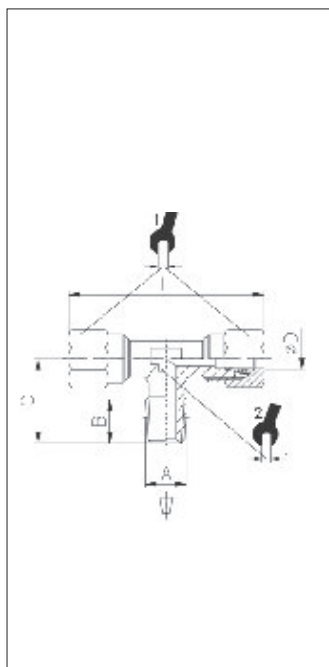

T MALE CONIQUE

CODE	ØD	A	B	C	L			
D409 4-1/8	4,0	R1/8	8,0	16,0	42,0	10	9	50
D409 6-1/8	6,0	R1/8	8,0	16,0	46,0	12	9	50
D409 6-1/4	6,0	R1/4	11,0	20,0	48,0	12	11	50
D409 8-1/8	8,0	R1/8	8,0	17,0	48,0	14	11	50
D409 8-1/4	8,0	R1/4	11,0	20,0	48,0	14	11	50
D409 8-3/8	8,0	R3/8	11,5	24,0	54,0	14	13	50
D409 10-1/4	10,0	R1/4	11,0	23,5	64,0	19	13	25
D409 10-3/8	10,0	R3/8	11,5	24,0	64,0	19	13	25
D409 12-3/8	12,0	R3/8	11,5	25,5	69,0	22	15	20
D409 12-1/2	12,0	R1/2	14,0	28,5	69,0	22	15	20
D409 14-1/2	14,0	R1/2	14,0	30,0	76,0	27	17	20
D409 15-1/2	15,0	R1/2	14,0	30,0	76,0	27	17	20
D409 16-1/2	16,0	R1/2	14,0	31,5	79,0	30	19	10
D409 18-1/2	18,0	R1/2	14,0	34,0	88,0	32	22	10

D410

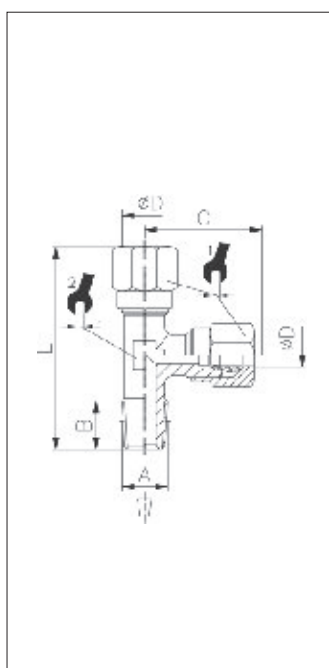

T BICONE LATERAL CONIQUE

CODE	ØD	A	B	C	L			
D410 4-1/8	4,0	R1/8	8,0	21,0	37,0	10	9	50
D410 6-1/8	6,0	R1/8	8,0	23,0	39,0	10	9	50
D410 6-1/4	6,0	R1/4	11,0	24,5	44,5	12	11	50
D410 8-1/8	8,0	R1/8	8,0	24,0	41,0	14	11	50
D410 8-1/4	8,0	R1/4	11,0	24,0	44,0	14	11	50
D410 8-3/8	8,0	R3/8	11,5	27,0	51,0	14	13	50
D410 10-1/4	10,0	R1/4	11,0	32,0	55,5	19	13	50
D410 10-3/8	10,0	R3/8	11,5	32,0	56,0	19	13	25
D410 12-3/8	12,0	R3/8	11,5	34,5	60,0	22	15	25
D410 12-1/2	12,0	R1/2	14,0	34,5	63,0	22	15	25
D410 14-1/2	14,0	R1/2	14,0	38,0	68,0	27	17	20
D410 15-1/2	15,0	R1/2	14,0	38,0	68,0	27	17	20
D410 16-1/2	16,0	R1/2	14,0	39,5	71,0	30	19	10
D410 18-1/2	18,0	R1/2	14,0	44,0	78,0	32	22	10

D408

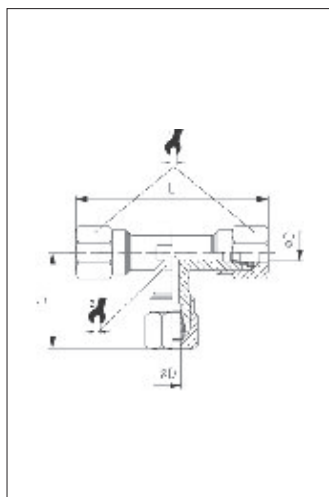

T EGAL

CODE	ØD	C	L			
D408 4	4,0	21,0	42,0	10	9	50
D408 6	6,0	23,0	46,0	12	9	50
D408 8	8,0	24,0	48,0	14	11	50
D408 10	10,0	32,0	64,0	19	13	25
D408 12	12,0	34,5	69,0	22	15	20
D408 14	14,0	38,0	76,0	27	17	10
D408 15	15,0	38,0	76,0	27	17	10
D408 16	16,0	39,5	79,0	30	19	10
D408 18	18,0	44,0	88,0	32	22	10

D411

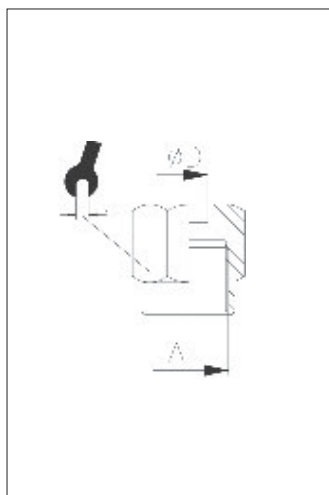

ECROU

CODE	ØD	A		
D411 4	4,0	M8x1	10	50
D411 6	6,0	M10x1	12	50
D411 8	8,0	M12x1	14	50
D411 10	10,0	M16x1,5	19	25
D411 12	12,0	M18x1,5	22	20
D411 14	14,0	M22x1,5	27	10
D411 15	15,0	M22x1,5	27	10
D411 16	16,0	M24x1,5	30	10
D411 18	18,0	M26x1,5	32	10

D412

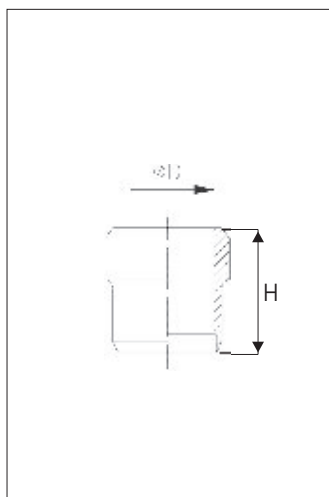

BAGUE

CODE	ØD	H	
D412 4	4,0	6,0	50
D412 6	6,0	7,0	50
D412 8	8,0	7,0	50
D412 10	10,0	10,0	25
D412 12	12,0	10,0	20
D412 14	14,0	10,0	10
D412 15	15,0	10,0	10
D412 16	16,0	10,0	10
D412 18	18,0	10,5	10

D414

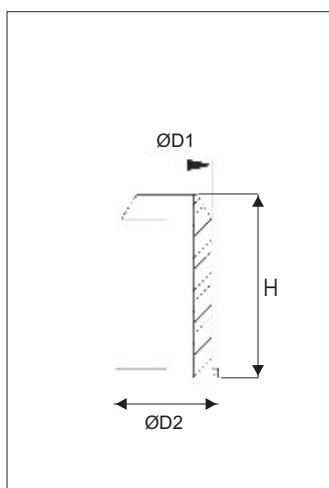

FOURRURE INTERIEURE

CODE	ØD1	ØD2	H	
D414 4	2,5	3,5	10,0	50
D414 6	4,0	5,5	12,0	50
D414 8	6,0	7,5	13,0	50
D414 9	6,0	7,5	13,0	50
D414 10	8,0	9,5	14,0	25
D414 12	10,0	11,5	16,0	20
D414 14	12,0	13,5	16,0	10
D414 15	12,5	14,5	17,0	10
D414 16	14,0	15,5	18,0	10



TRANSMATIK

TRANSMATIK

4 RUE DES ESSIOS
51430 BEZANNES

TEL : 03.26.86.45.42
FAX : 03.26.86.49.11
www.transmatik.fr

Informations : ma.bur@transmatik.fr

ACCESSOIRES PNEUMATIQUES